

MARK	CONTENT OF MENDMENT	DATE	DRAW

This document is the property of JINPAT Electronics Co., Ltd (ShenZhen) (Hereafter "JINPAT"). It is lent and is to be returned upon request. The contents of this document are confidential and constitute trade secrets proprietary to JINPAT. Its contents document nor its contents shall be disclosed to any unauthorized person copied or published without JINPAT prior written consent.
COPY RIGHT @ 2018 JINPAT ELECTRONICS Co., Ltd (ShenZhen)

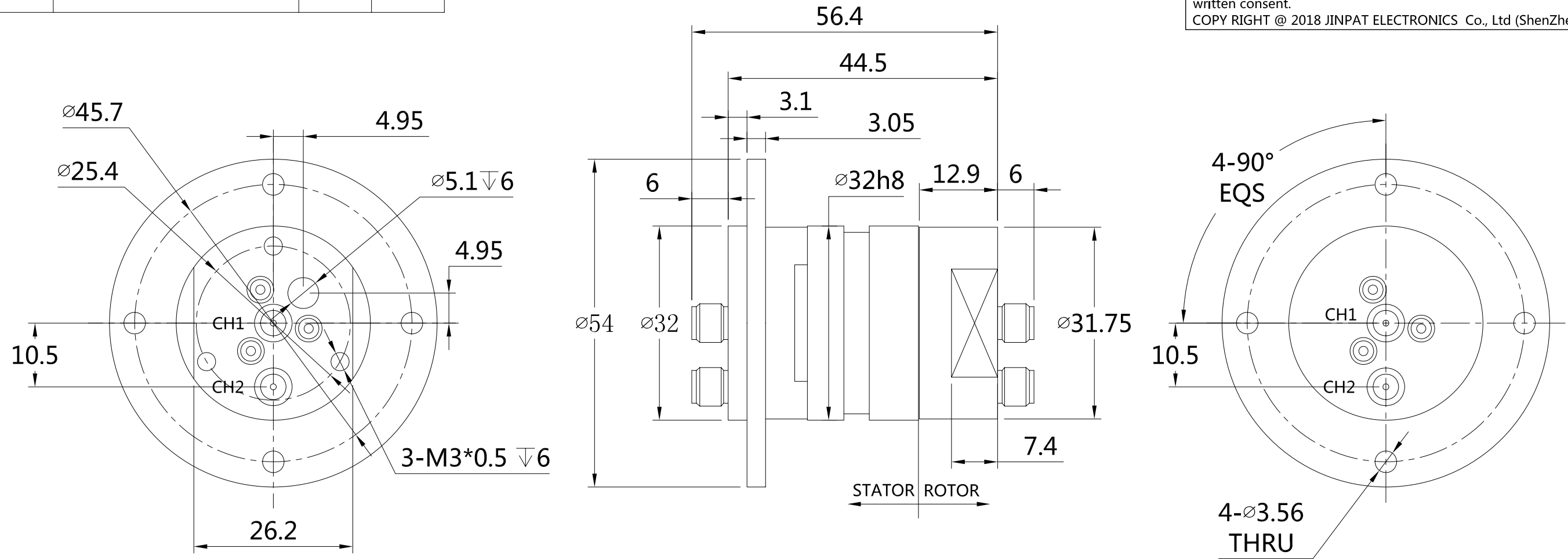

Specifications

Channel	CH1	CH2	Starting Torque	0.05Nm@ room temperature
Interface Type	SMA-F (50ohm)	SMA-F (50ohm)	Continuous Rotational Torque	0.05Nm@ room temperature
Type	I	I	Rotating Speed, Max.	60rpm
Frequency Range	DC-4.5GHz	DC-4.5GHz	Life Time, Min.	10 million Revolutions
Peak Power, Max.	1000W	1000W	Body Material	Aluminum alloy
Average Power, Max.	60W@4.5GHz	10W	Case surface finish	Chromate conversion coat
VSWR, Max.	1.2	1.5	Weight , approx	0.13Kg
VSWR WOW	0.05	0.2	IP Protection Level	IP60
Insertion Loss, Max.	0.25dB	0.3dB	Operation Temperature	-45 ~ +80°C
Insertion Loss WOW	0.05dB	0.15dB	Storage Temperature	-55 ~ +85°C
DC capability, max. (one channel only)	0.5 A, 48 VDC @ full RF avg. power	0.5 A, 24 VDC @ full RF avg. power	Humidity (Operation)	95%
Phase WOW	0.5 deg	4.0 deg	Humidity (Storage)	95%
Isolation , min.	50dB			

JINPAT Electronics Co.,Ltd (ShenZhen) 晶沛电子有限公司 (深圳)		型号 MODEL		LPHF-02A	
单位 UNIT	mm	TOL UNLESS SPECIFIED 非特殊公差如下 LINEAR(线度) 0--18 ±0.1 >18--80 ±0.15 >80--250 ±0.2 ANGLE(角度) x° ±0.5°		名称 TITLE	Coaxial Rotary Joint
比例 SCALE	1:1			编号 PART NO.	PHF02A0001
视角 PROJ.				材料 MATERIAL	/
设计 DESIGN	XHH	日期 DATE	2018.03.10	表面要求 FINISHED	/
审核 CHECKED	CRJ	日期 DATE	2018.03.10	版本 VERSION	A1
工艺 TECHNICS	PXF	日期 DATE	2018.03.10	页数 PAGE	1/1
标准化 STANDARD	GMH	日期 DATE	2018.03.10		